



Защищаем почту и периметр

Андрей Каганцов

IT инженер

e-mail: akagantsov@polikom.ru

ПОЛИКОМ ПРО

Просто работаем

Kaspersky для Microsoft ISA/TMG

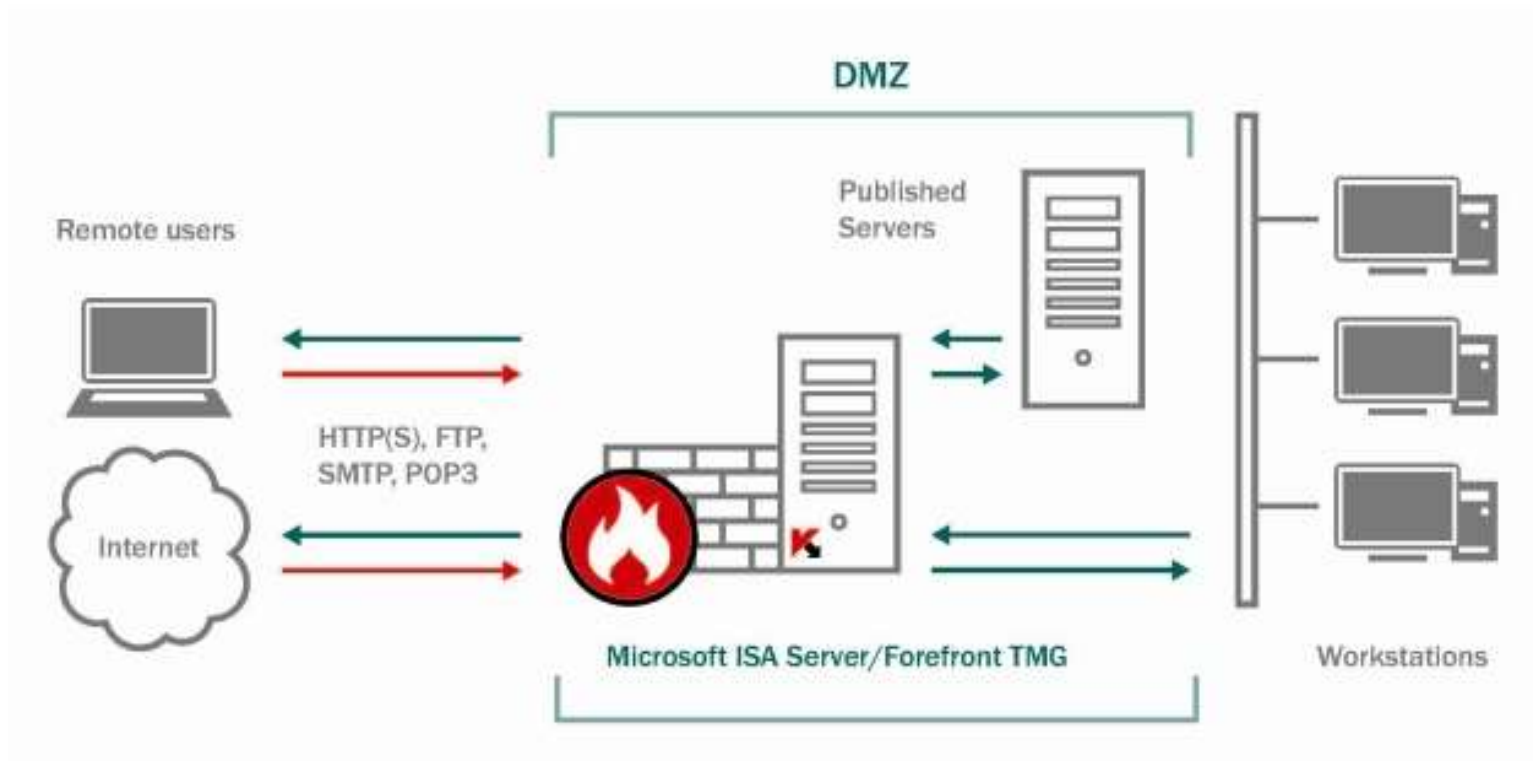

Kaspersky для Microsoft Exchange

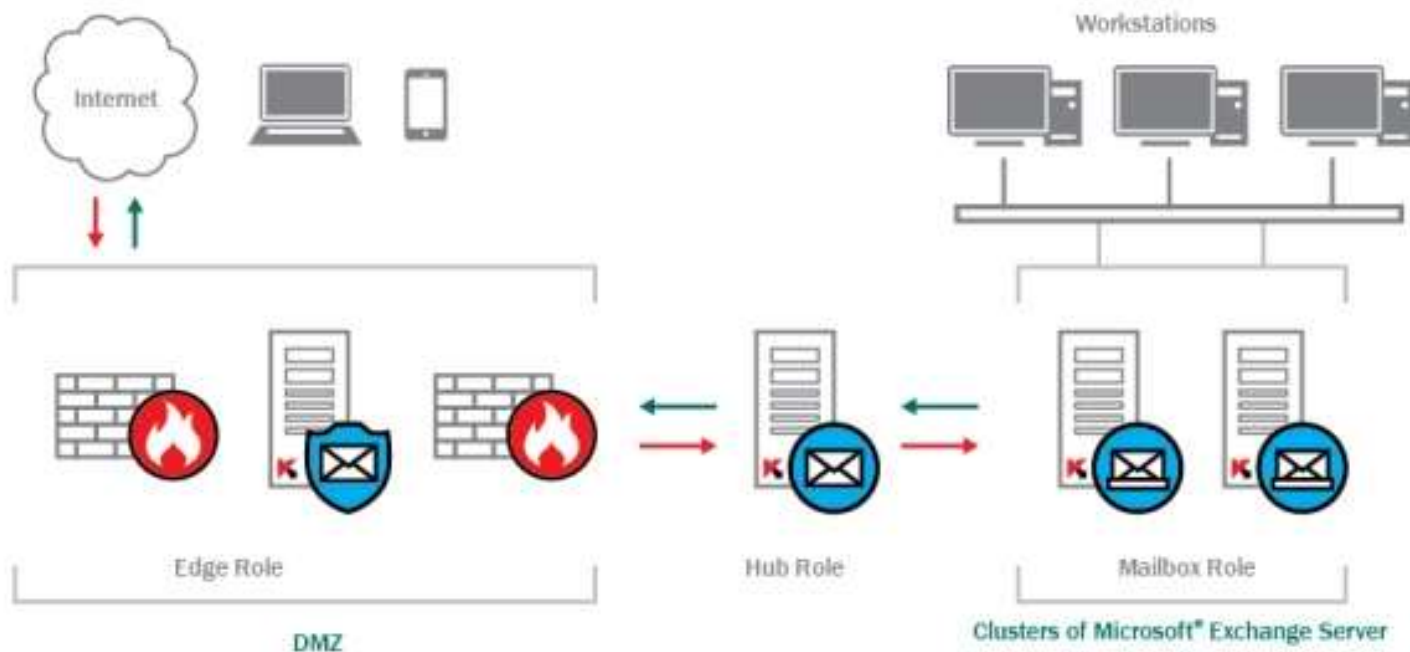

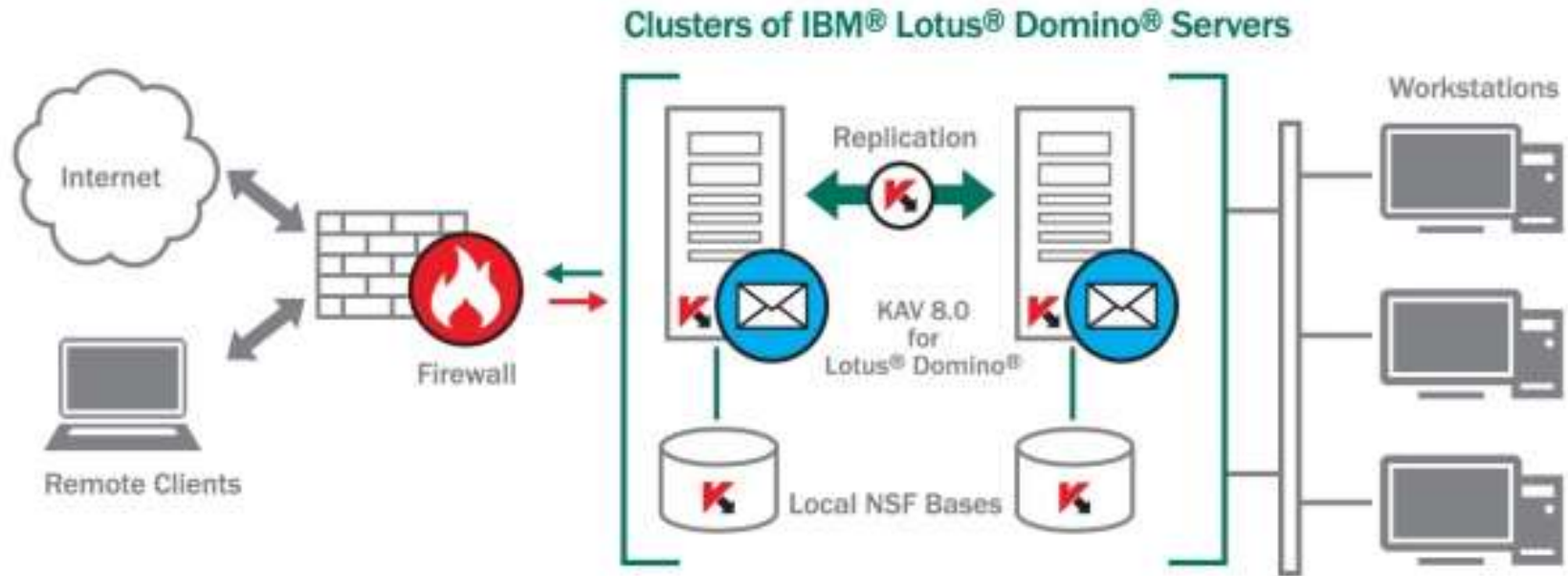

Kaspersky for Linux Mail Server/ Kaspersky Secure Mail Gateway

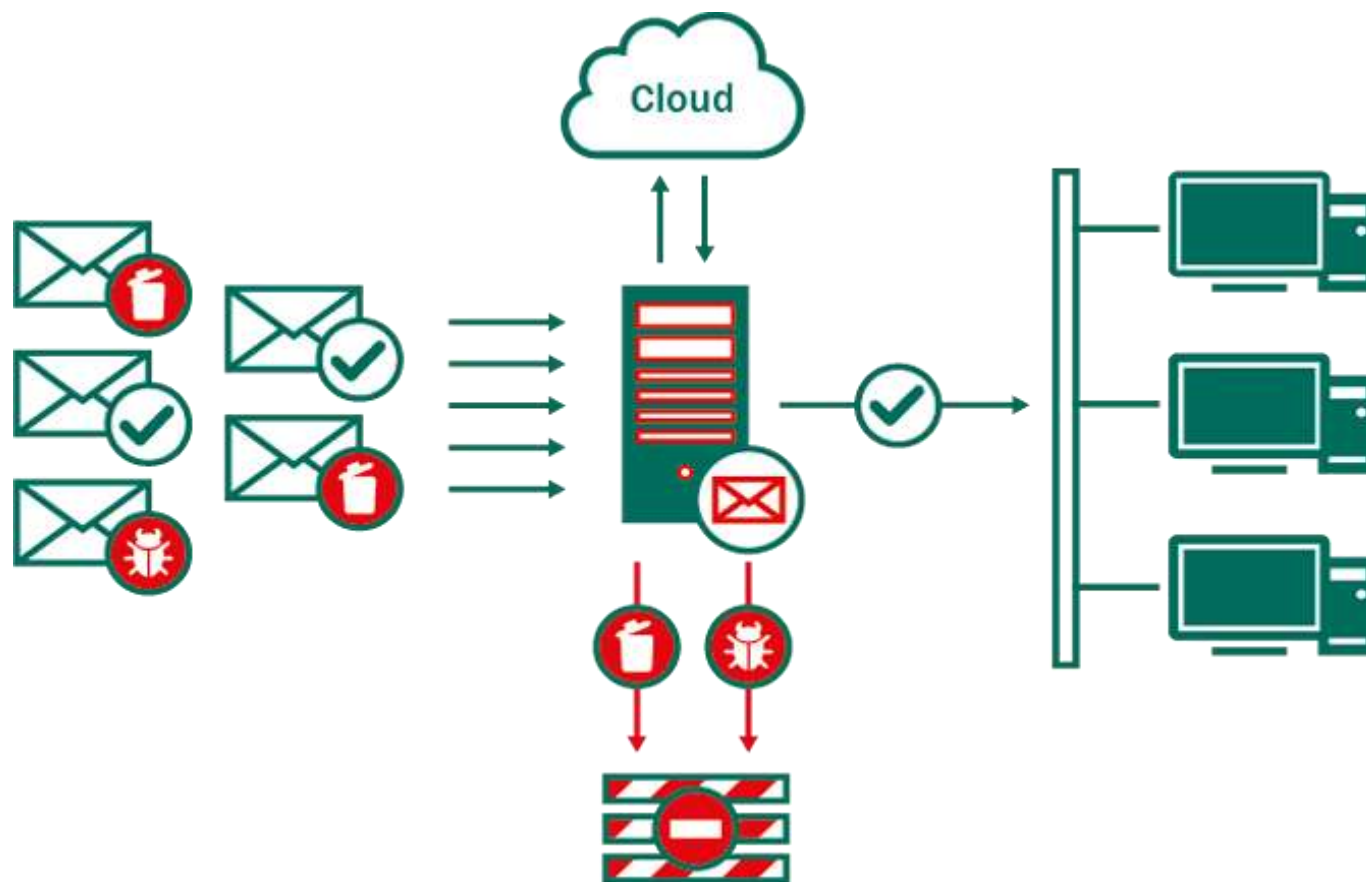

Kaspersky Secure Mail Gateway



The image shows the login interface for Kaspersky Secure Mail Gateway. It features a central light blue box on a dark grey background. At the top left of the box is the Kaspersky logo, a green hexagon with a white envelope icon. To the right of the logo, the text "Kaspersky Secure Mail Gateway" is displayed. Below the logo and text are two input fields: "User name" and "Password". Under the "User name" field, there is a small "i" icon. Below the "Password" field, there is a small "x" icon. At the bottom left of the box, there is a "Language:" label followed by a dropdown menu showing "English" and a small downward arrow. At the bottom right of the box, there is a "Login" button.

Kaspersky Secure Mail Gateway (Install)



Спасибо за внимание!



Андрей Каганцов

ИТ-инженер

тел: + 7 (812) 325 84 00

e-mail: akagantsov@polikom.ru

ПОЛИКОМ ПРФ

Просто работаем